

ISOMETRIC VIEW

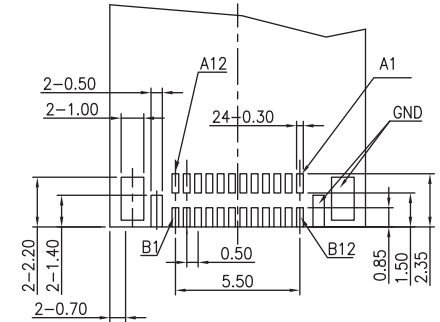
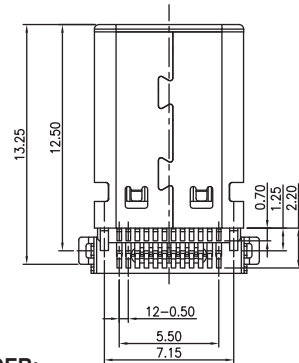
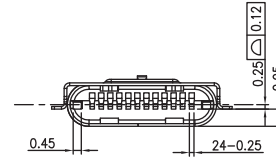
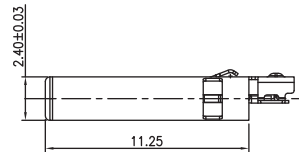
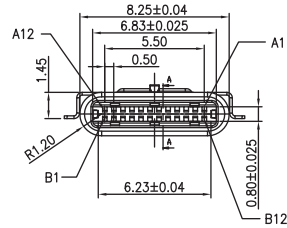
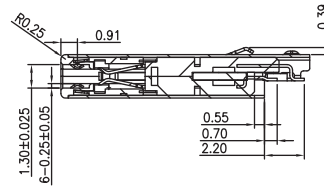
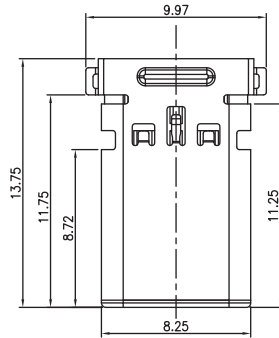

RECOMMENDED PCB LAYOUT

ELECTRICAL:

CURRENT RATING: 5A Min. for VBUS,
1.25A Min. for Other

CONTACT RESISTANCE:
< 40 milliohm Max.

INSULATION RESISTANCE:
> 100 Mgeaohm Min.

DIELECTRIC WITHSTANDING VOLTAGE:
100 VAC for 1 Minute

OPERATING TEMPERATURE: - 40° C ~ 85° C

MATERIAL:

INSULATOR: LCP, UL94V-0

CONTACTS: Copper Alloy

CONTACT PLATING:

Gold Plating over 50u" Nickel on Contact Area,
80u" Tin/ Plating over 50u" Nickel on Solder Area

SHELL: Stainless Steel with 50u" Nickel Plating

Mechanical:

INSERTION FORCE: 5 ~ 20N Max.

WITHDRAWAL FORCE: 8 ~ 20N Kg

DURABILITY: 10,000 Cycles

HOW TO ORDER:

U X 1 5 - 0 2 0 3 - 3 0 X X - Z

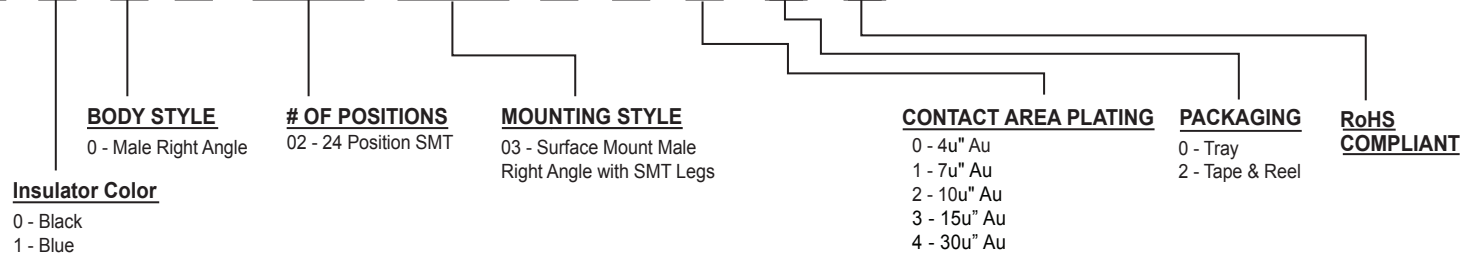

Rev	Drawn	Checked	Approved	Date
0	B.S.	S.M.	S.M.	09/08/16

SMP TECHNOLOGY, INC.

USB 3.1 Male Connector, Surface Mount , Shell & Contacts, 1.45mm Offset