

ISOMETRIC VIEW

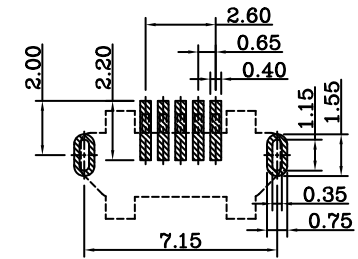
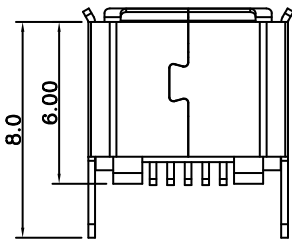
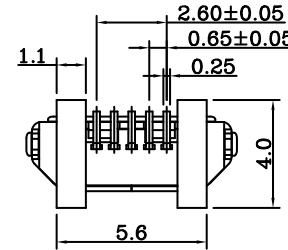
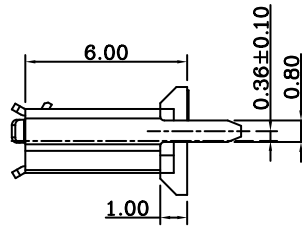
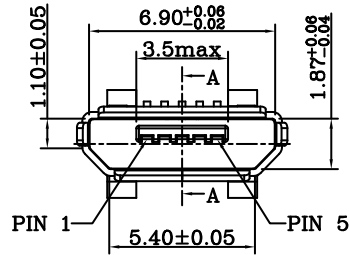

RECOMMENDED PCB LAYOUT

**ELECTRICAL:**

VOLTAGE RATING: 30 Volts AC (RMS)  
 CURRENT RATING: Signal Pins (2,3,4) 1 AMP, Power Pins (1,5) 1.8 AMP  
 DIELECTRIC STRENGTH: 100V AC 1 Minute  
 INSULATION RESISTANCE: 100 MΩ Min.  
 CONTACT RESISTANCE: 30 mΩ Max.

**MATERIALS:**

HOUSING: High Temperature Thermoplastic, UL94-VO  
 COLOR: Black  
 CONTACTS: Copper Alloy  
 SHELL: Steel  
 TEMPERATURE RANGE: -30°C to +85°C

**HOW TO ORDER:**

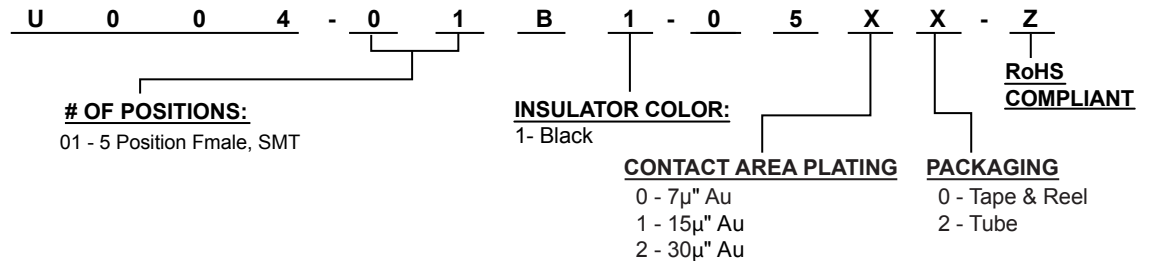

Rev	Drawn	Checked	Approved	Date
0	B.S.	S.M.	S.M.	06/12/13

**SMP TECHNOLOGY, INC.**

Micro USB 2.0, 5 Position, Receptacle, Vertical, SMT

Tolerance : Dimension .X +/- 0.30 .XX +/- 0.20 .XXX +/- 0.10

SERIES: U004-01B1-05XX-Z