

SECTION A-A

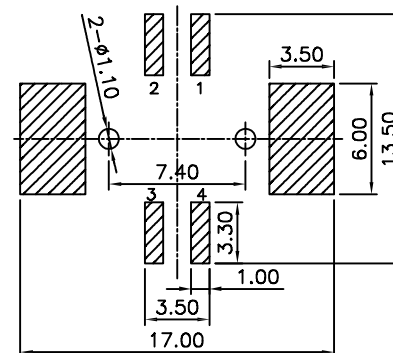
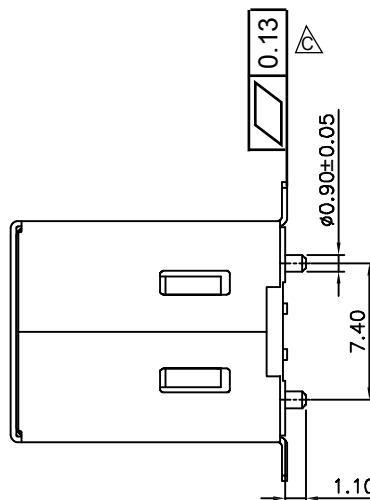

TOP VIEW
RECOMMENDED PCB LAYOUT

ELECTRICAL:

CURRENT RATING: 1A at 30V AC
CONTACT RESISTANCE:
30 Milliohm Max.

INSULATION RESISTANCE:
1000 Megaohm Min.

DIELECTRIC WITHSTANDING VOLTAGE:
500V AC (rms) AC for 1 Minute

MATERIAL:

INSULATOR: High Temp Nylon (Nylon 9T)
CONTACTS: Phosphor Bronze
CONTACT PLATING: Gold Plating over Nickel on Contact Area,
Tin Plating over Nickel on PCB Tail
SHELL: Copper Alloy, Nickel Plated

MECHANICAL

MAX PROCESS TEMP: 260°C for 5 Seconds

HOW TO ORDER:

U 0 0 2 - 0 4 3 X - 1 2 2 - Z X

NUMBER OF CONTACTS:
04 - 4 PIN SINGLE PORT

ORIENTATION:
3 - Vertical, Surface Mount

INSULATOR COLOR:
0 - Black
1 - White

**RoHS
COMPLIANT**

CONTACT PLATING:
2 - SELECTIVE GOLD

PACKAGING

Blank - Tray Package
1 - Tape & Reel (Standard)
2 - Tube
3 - Tape & Reel
w/out Kapton Tape

Rev	Description	Drawn	Checked	Approved	Date
0	Issued	B.S.	S.M.	S.M.	02/06/13
A	Revised for Insulator Material	B.S.	S.M.	S.M.	03/06/13
B	Added Packaging Option 3	B.S.	S.M.	S.M.	09/08/16
C	Revised Dimensions; Added Flatness Callout	B.S.	S.M.	S.M.	11/03/16

SMP TECHNOLOGY, INC.

USB Connector 4 Pin, Type B, Vertical, Surface Mount,