

Contact Number	Signal Name
PIN1	VBUS
PIN2	D-
PIN3	D+
PIN4	GND
PIN5	Std A _SSRX-
PIN6	StdA _SSRX+
PIN7	GND _DRAIN
PIN8	StdA _SSRX -
PIN9	StdA _SSRX +
Shell	Shield

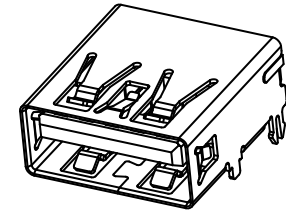

Isometric View

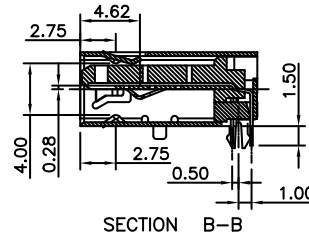
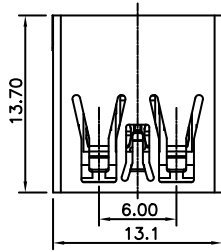
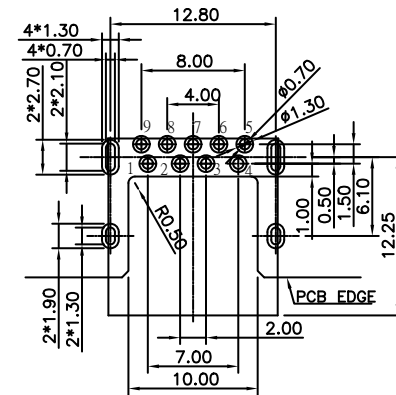
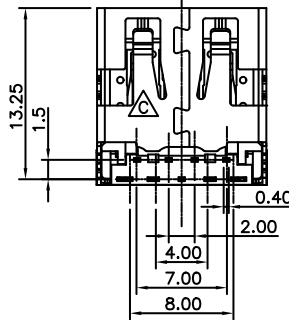
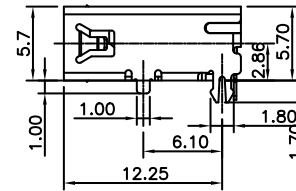
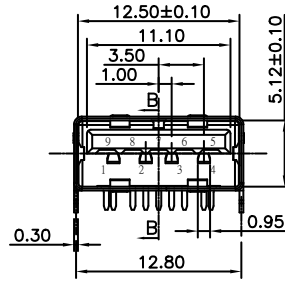

Recommended P.C.B. Layout

ELECTRICAL:

CURRENT RATING: 1.5 Amps (Max)

Applied to V bus pin and corresponding ground pin;
.25 Amp (Min) For All Remaining Contacts

CONTACT RESISTANCE:

30 milliohm Max (initial) for V bus and
ground contacts. 50 milli ohms all other contacts.

INSULATION RESISTANCE:

100 Megaohm min @ 100VDC

DIELECTRIC WITHSTANDING VOLTAGE:

100V (rms) AC for 1 Minute

OPERATING TEMPERATURE: -40° C to +85° C

HOW TO ORDER:

U 0 0 1 - 0 9 E 2 - J 0 X 0 - Z X

NUMBER OF CONTACTS:

09 - 9 Pin Female

INSULATOR COLOR:

2 - Blue (Pantone 300C)

NUMBER OF LOCKS:

0 - Standard 2 Locks
(Top, Bottom, Sides)

RoHS COMPLIANT

PACKAGING

Blank - Tray
1 - Tape & Reel
2 - Tube

DEFINITION:

E - Short Body, Right Angle,
Thru Hole, Std. Orientation

SELECTIVE CONTACT PLATING:

1 - 5u" Gold
2 - 15u" Gold
3 - 30u" Gold
4 - 6u" Au Plating

MATERIAL:

INSULATOR: Thermoplastic LCP E1301

Blue (Pantone 300C)

CONTACTS: Phosphor Bronze

CONTACT PLATING: Gold Plating in Contact Area; 50u" Nickel Subplate Overall;
Solder Tails : 100u" Matte Tin

SHELL: Copper Alloy

SHELL PLATING: 80u" Nickel Overall

PACKAGING: Tape & Reel

Rev	Drawn	Checked.	Approved	Date
0	Issued B.S.	S.M.	S.M.	08/10/17

SMP TECHNOLOGY, INC.

USB 3.0 Connector, A Type, Female, Surface Mount, Short Narrow Body