

ISOMETRIC VIEW

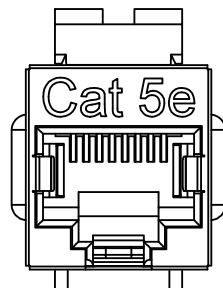

METAL PANEL

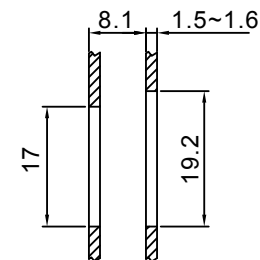
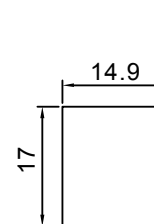

PLASTIC PANEL

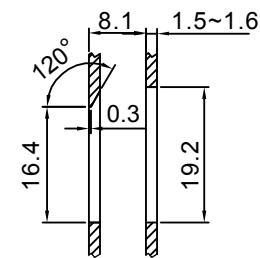
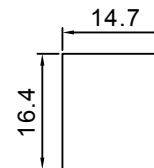

RECOMMENDED PANEL CUTOUT

**HOW TO ORDER:**

**M** 0 0 7 - 8 8 0 1 - 2 1 4 - Z

**P: NUMBER OF POSITIONS**  
**C: NUMBER OF CONTACTS**  
 88-8P8C

**ORIENTATION:**  
 1 - Reverse

**GOLD PLATING:**  
 4-50u" Au

2 - CAT 5e SHIELDED

**RoHS COMPLIANT**

**ELECTRICAL:**

CURRENT RATING: 1.5 AMPS MAX. DC  
 INSULATION RESISTANCE: 500 Megaohms  
 DIELECTRIC WITHSTANDING VOLTAGE:  
 1000V (rms) AC for 1 Minute  
 DC RESISTANCE: 0.1 Ohm  
 CONTACT RESISTANCE: 20 Miliohms

**MATERIAL:**

COUPLER HOUSING: Polycarbonate, UL94V-0  
 CONTACT HOLDER: Polycarbonate, UL94V-0  
 CONTACT: Phosphor Bronze, 50u" Gold Plating

**MECHANICAL:**

DURABILITY: 750 Mating Cycles with FCC Compliant 8P Plug  
 CONTACT FORCE: 100 grams with FCC Compliant 8P Plug  
 PLUG RETENTION FORCE: 11 LBF min  
 OPERATING TEMPERATURE: - 10° to 60° C  
 STORAGE TEMPERATURE: - 40° to 68° C  
 HUMIDITY: 10% - 90% RH

Rev	Drawn	Checked	Approved	Date
0	B.S.	S.M.	S.M.	05/04/18

**SMP TECHNOLOGY, INC.**

CAT 5e Inline Coupler, Mini Body, Shielded, Reverse Orientation