

DISTANCE BETWEEN CONNECTORS DIMENSION(mm)

OPTION	E	F
1	15.88	28.42
2	19.05	31.60
3	22.86	35.41

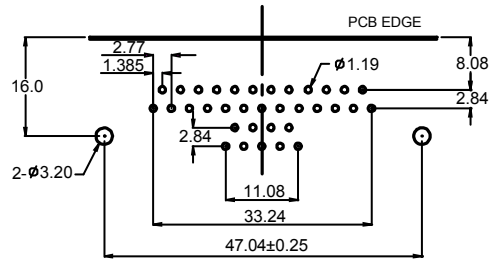
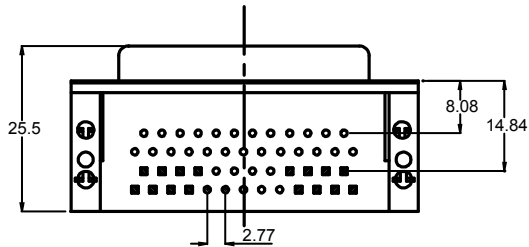

ELECTRICAL:

CURRENT RATING: 5A
 VOLTAGE RATING: 300VDC
 OPERATING VOLTAGE: 500V
 CONTACT RESISTANCE:
 < 15 Milliohm Max.
 INSULATION RESISTANCE:
 > 1000 Megaohm Min. at 500VDC
 DIELECTRIC WITHSTANDING VOLTAGE:
 1000V (rms) for 1 Minute
 OPERATING TEMPERATURE: -55°C to +105°C

MATERIAL:

INSULATOR: THERMOPLASTIC
 W/ GLASS FIBER FILLED (UL94V-0)
 CONTACT: COPPER ALLOY
 SHELL: STEEL
 CONTACT PLATING: GOLD ON MATING SURFACE
 Sn-Pb ON TERMINATION END
 ALL OVER 50 μ" NICKEL

HOW TO ORDER:

A 2 5 - 1 0 9 - 1 2 5 - 1 X 4 0 X - Z

TOP CONNECTOR CONTACT TYPE:
 1 - FEMALE
 2 - MALE

BOTTOM CONNECTOR CONTACT TYPE:
 0 - N/A
 1 - FEMALE
 2 - MALE

TOP CONNECTOR NUMBER OF CONTACTS:
 09, 15, 25

BOTTOM CONNECTOR NUMBER OF CONTACTS:
 00, 09, 15, 25

DISTANCE BETWEEN CONNECTORS:
 SEE TABLE

MOUNTING OPTION:
 4 - SEE PAGE 2

HARDWARE:
 0 - W/OUT JACK SCREW
 J - W/ JACK SCREW

PLATING OVERALL:

0 - FULL Au
 4 - 10u" Au
 5 - 15u" Au
 7 - 30u" Au
 8 - FULL TIN

SELECTIVE PLATING:

1 - Au CONTACT AREA/TIN TAIL
 9 - 15u" Au CONTACT AREA/TIN TAIL
 A - 30u" Au CONTACT AREA/TIN TAIL

RoHS COMPLIANT

Rev	Drawn	Checked	Approved	Date
0	S.E.	S.M.	S.M.	3/15/99
A	A.M.	S.M.	S.M.	2/13/02
B	B.S.	S.M.	S.M.	5/17/07

SMP TECHNOLOGY, INC.
 Dual D-Sub Connector, 9 Position Female Over 25 Position Female

SCALE:n/a	MAT'L	FINISH
TOL. DEC.	.X +/-0.25	.XX +/- 0.10
	.XXX +/- 0.05	ANGLE +/-2°
	UNIT: mm	

P/N: A25-109-125-1X40X-Z Pg: 1

OPTION 1:
FOUR .125 DIAMETER
NON-THREADED
MOUNTING HOLES

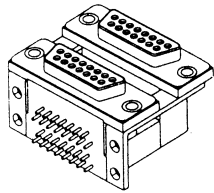

OPTION 2:
FOUR THREADED 4-40
MOUNTING HOLES

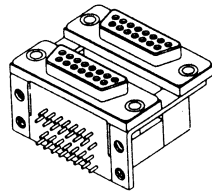

OPTION 3:
FOUR GROUNDING
BRACKETS

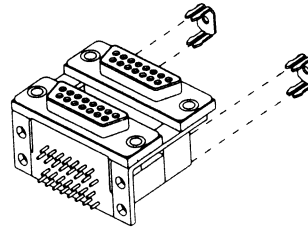

OPTION 4:
TWO GROUNDING
BRACKETS

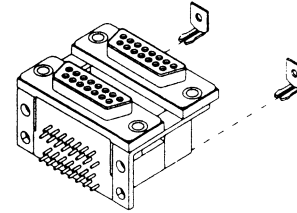

Rev		Apv.	Date	SMP TECHNOLOGY, INC.
SCALE	MAT'L	FINISH	MOUNTING OPTIONS	
				SERIES: A 2 5
				Pg: 2