

Recommended PCB Layout

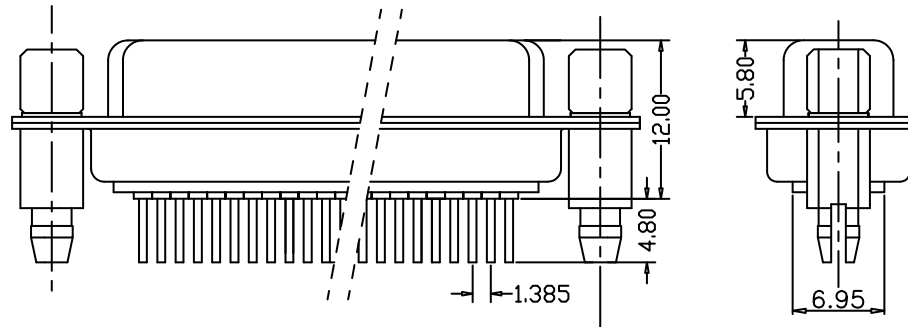
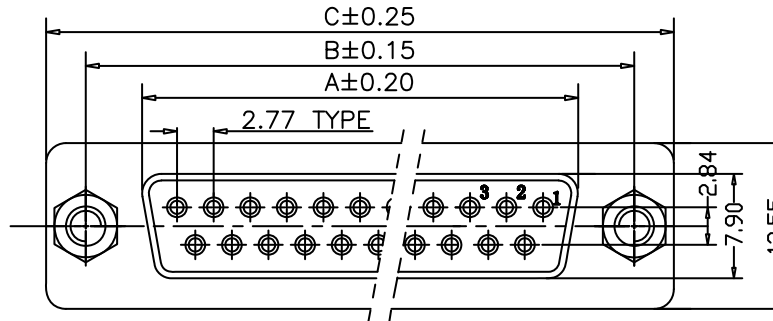

NOTE:
Mounting Option "15"
Shown - See Page 2

DIMENSION(mm)

CONTACTS	A	B	C
9	16.33	24.99	30.81
15	24.66	33.32	39.14
25	38.38	47.04	53.04
37	54.84	63.50	69.32

HOW TO ORDER:

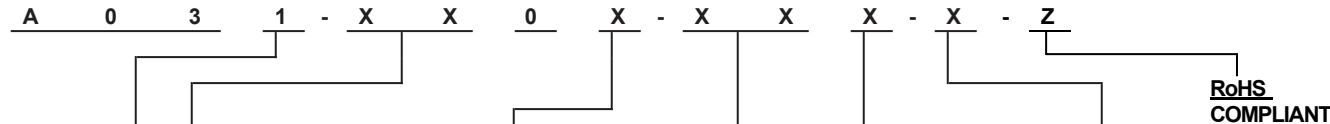

ELECTRICAL:

CURRENT: 5A
 CONTACT RESISTANCE: < 30mΩ
 INSULATOR RESISTANCE: > 1000MΩ
 DIELECTRIC WITHSTANDING VOLTAGE: 1000VAC FOR 1 MIN.
 OPERATING TEMPERATURE: -55° C TO +105° C

MATERIAL:

CONTACT: COPPER ALLOY
 INSULATOR: PBT & 30% GLASS FIBER (UL94V-0)

CONTACT TYPE:
1 - FEMALE

NUMBER OF CONTACTS:
SEE CONTACT
NUMBER ABOVE

SHELL PLATING:
1 - TIN PLATED
4 - NICKEL PLATED

MOUNTING OPTION:
SEE PAGE 2

PLATING OVERALL:
0 - FULL Au FLASH
4 - 10u" Au
5 - 15u" Au
7 - 30u" Au
8 - FULL TIN

SELECTIVE PLATING:
1 - Au FLASH CONTACT AREA/TIN TAIL
9 - 15u" Au CONTACT AREA/TIN TAIL
A - 30u" Au CONTACT AREA/TIN TAIL

INSULATOR COLOR:
BLANK - BLACK
1 - WHITE
2 - BLUE
3 - GRAY

**RoHS
COMPLIANT**

Rev	Drawn	Checked	Approved	Date
0 Issued	B.S.	S.M.	S.M.	11/05/14
A Added Mounting Options	B.S.	S.M.	S.M.	11/12/14

SMP TECHNOLOGY, INC.

D-SUB CONNECTOR, STRAIGHT, PCB TYPE, FEMALE

STAMPED & FORMED CONTACT

A031 & A032 MOUNTING OPTIONS

MOUNTING OPTION 10

3.05 MM DIAMETER NON-THREADED MOUNTING HOLE

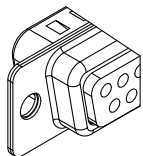

MOUNTING OPTION 11 :

RIVETED 4-40 UNC SCREW LOCK
4.0 mm ON BACK SIDE OF SHELL

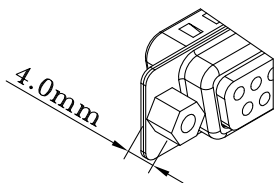

MOUNTING OPTION 12 :

RIVETED 4-40 UNC SCREW LOCK ON
FRONT SIDE OF SHELL

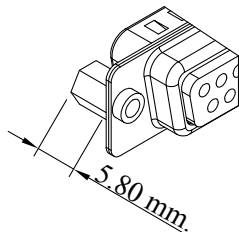

MOUNTING OPTION 14 :

4.1 mm RIVETED 4-40 SCREW LOCK
ON BOTTOM SIDE OF SHELL

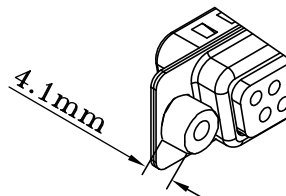

MOUNTING OPTION 16 :

3.5 mm RIVETED 4-40 SCREW LOCK
ON BOTTOM SIDE OF SHELL

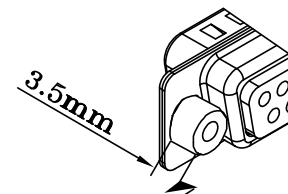

* For Mounting Options 11, 12 & with Nylok installed on inside threads - replace the "1" with the letter L. Example: Option 11 with Nylok installed - use mounting option L1.

MOUNTING OPTION 17 :

RIVETED 4-40 UNC SCREW LOCK ON
FRONT SIDE OF SHELL

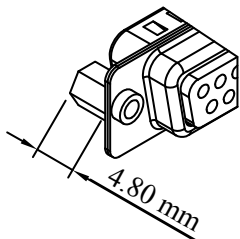

MOUNTING OPTION 19 :

RIVETED 4-40 UNC SCREW LOCK
5.8mm ON BACK SIDE OF SHELL

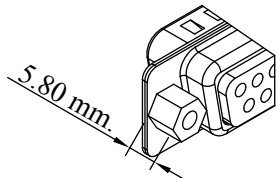

MOUNTING OPTION 20:

RIVETED 5.80 mm 4-40 UNC SCREW
LOCK ON BACK SIDE OF SHELL; 5.80
mm UNC SCREWLOCK ATTACHED
TO FRONT SIDE OF SHELL

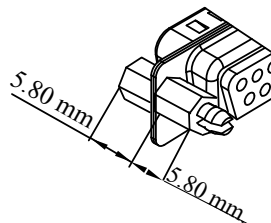

MOUNTING OPTION 21:

RIVETED 5.80 mm 4-40 UNC SCREW
LOCK ON BACK SIDE OF SHELL; 4.80
mm UNC SCREWLOCK ATTACHED
TO FRONT SIDE OF SHELL

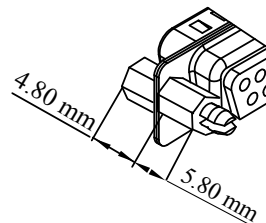

MOUNTING OPTION 22:

RIVETED 5.80 mm 4-40 UNC SCREW
LOCK ON BACK SIDE OF SHELL;

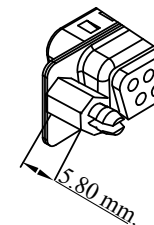

MOUNTING OPTION 23:

RIVETED 5.80 mm 4-40 UNC SCREW
LOCK ON BACK SIDE OF SHELL;

